

FREEHOLD



House - Semi-Detached (EPC Rating: F)

**STUDLEY ROAD,,
DAGENHAM,,RM9 6BE.**

Guide Price

£425,000

STEPS

Estate Agents



3



2



2



F

3 Bedroom House - Semi-Detached located in Dagenham

EXTENDED semi detached house on LARGE CORNER PLOT. Three double bedrooms (one with en-suite shower) Good size open plan lounge, kitchen, LARGE REAR EXTENSION. Guide Price £425,000 £450,000

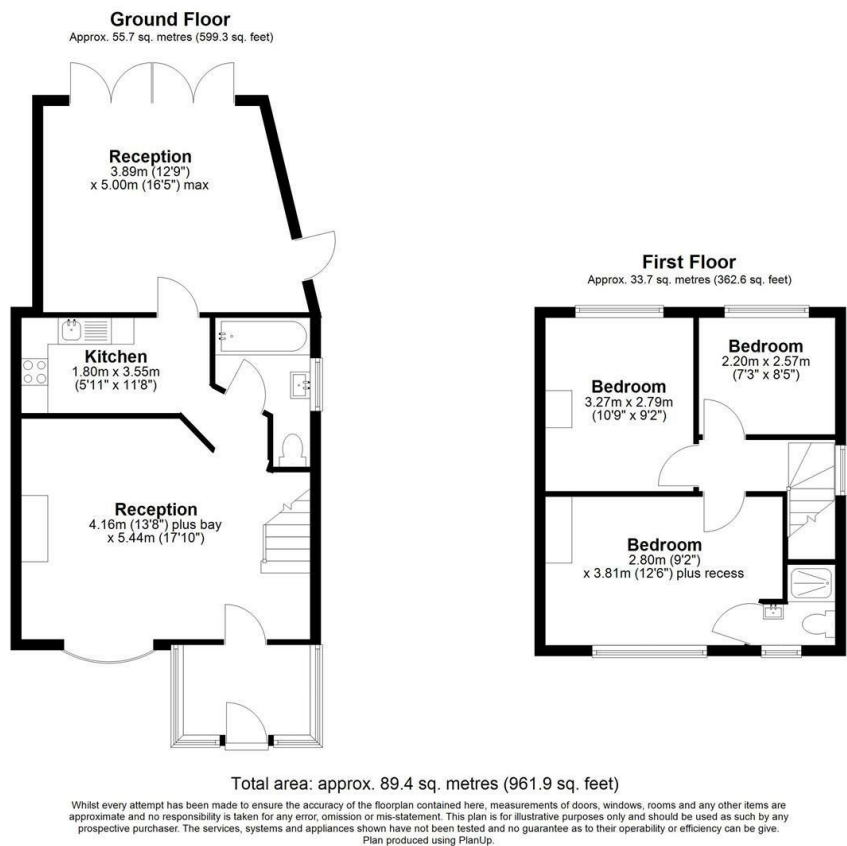

Council Tax Band
C
Energy Performance Graph

Call us on
020 8593 5933
dagenham@steps.me.uk
www.steps.me.uk

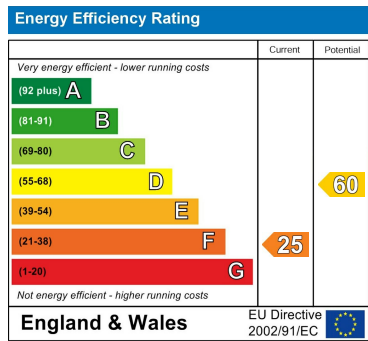

Agents Note: Whilst every care has been taken to prepare these particulars, they are for guidance purposes only. All measurements are approximate and are for general guidance purposes only and whilst every care has been taken to ensure their accuracy, they should not be relied upon and potential buyers are advised to recheck the measurements.